



7-123 Hinge Pr01 180° Stainless Steel



Avantages

- Screw-on hinge for flush door/frame construction, lightweight version.
- For nested doors.
- Hinge visible.
- RH / LH application.
- 180° Opening angle.

Materials

- **Hinge:** AISI 303

Notes

M6 stud, 3 nuts and serrated washers are included.

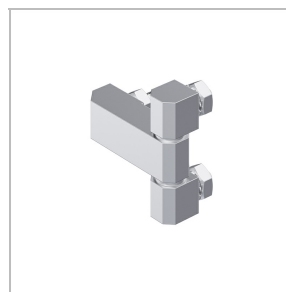

Hinge

	Part Number	A	L	Pin version	Installation type	Delivery Unit
a)	219-9006.00-00000	30 mm	45 mm	loose	screw-on	10 pcs.
b)	219-9007.00-00000	38 mm	53 mm	loose	screw-on	10 pcs.

