



1-050 Quarter-Turn Pr14.1 L13.5



Advantages

- IP65 to DIN EN 60529 by using sealing kit (optional).
- RH / LH application.
- On request parts can be assembled.
- A pre-assembled quarter-turn can be installed in the cutout and combined with the finger pull of product system 1-060.
- Grounding by grounding nut or grounding clip.

Materials

- **Housing:** zinc die, chrome plated or black or PA, black

Remarks

With assembled cam - door thickness (S) max. 2mm
With unasssembled cam - door thickness (S) max. 5mm
1. nut
2. grounding nut
3. grounding clip
When using finger pull (b) the H-dimension decreases by 0.8mm
Please configure the quarter-turn with insert and cam.



Quarter-Turn housing + nut

	Part Number	Material	Surface	Grounding type	Installation type	Delivery Unit
a)	220-9001.00-00000	zinc die	chrome plated		screw-on	10 pcs.
a)	220-9002.00-00000	zinc die	chrome plated	Grounding nut	screw-on	10 pcs.
a)	220-9005.00-00000	zinc die	chrome plated	Grounding clip	screw-on	10 pcs.
a)	220-9003.00-00000	zinc die	black		screw-on	10 pcs.
a)	220-9004.00-00000	zinc die	black	Grounding nut	screw-on	10 pcs.
a)	220-9006.00-00000	zinc die	black	Grounding clip	screw-on	10 pcs.
a)	220-9020.00-00000	PA	black		screw-on	10 pcs.
a)	220-9021.00-00000	PA	black	Grounding nut	screw-on	10 pcs.
a)	220-9022.00-00000	PA	black	Grounding clip	screw-on	10 pcs.

Function

 extension

209-9003.00-00000 **Sealing kit IP65 for Quarter-Turns Pr14.1**

Assembly options

220-0001.00-00000 **Assembling cam without o-ring**

220-0002.00-00000 **Assembling cam with o-ring**

220-0006.00-00000 **Assembling cam 90° to wing knob without o-ring**

220-0007.00-00000 **Assembling cam 90° to wing with o-ring**

Accessories

c) 1-058 **Cams for Quarter-Turn Pr14.1**

b) 1-059 **Finger Pull and Inserts for Quarter-Turn Pr14.1**

6-100 **Wrenches and Keys**

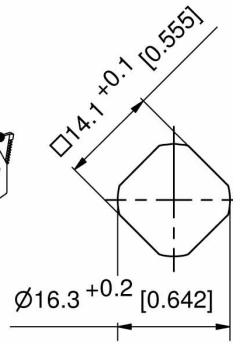
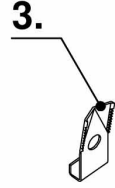
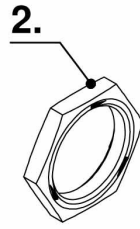
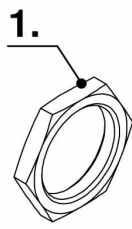
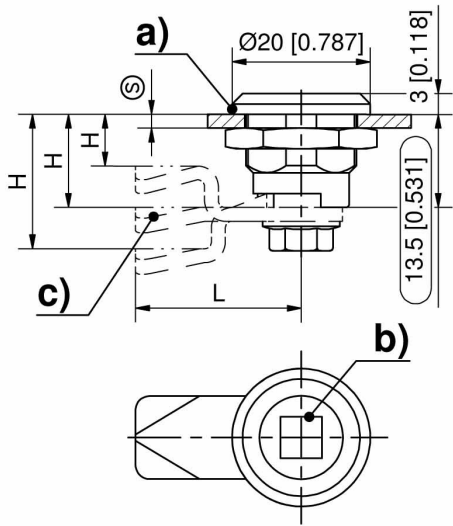

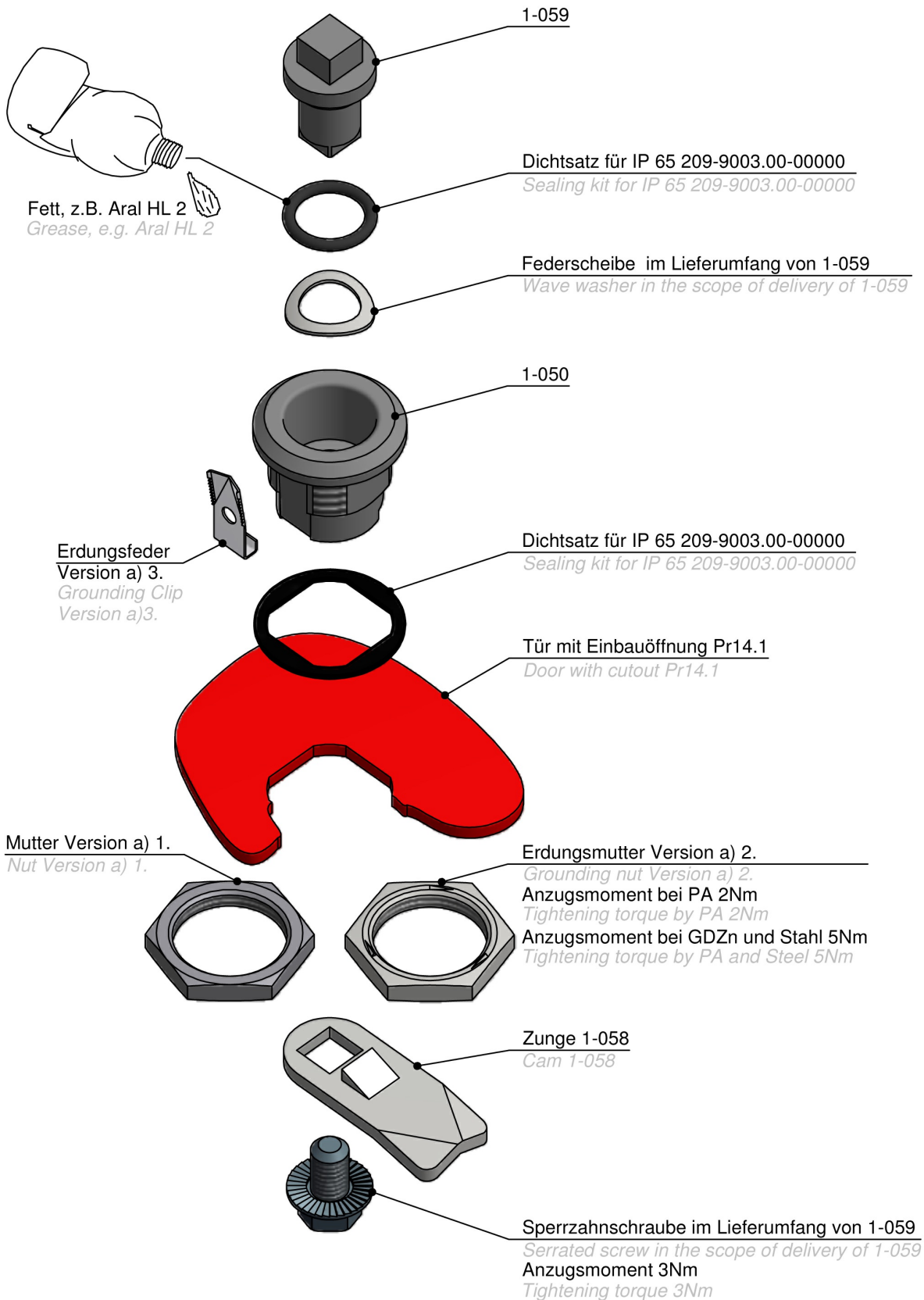



1-058 Cams for Quarter-Turn Pr14.1



RoHS
WEEE

Advantages

- Cams, L- and H-dimension fixed.
- Special cams, L- and H-dimension variable.
- Special cams with star connection, L- and H-dimension variable.

Materials

- **Cams:** steel, zinc plated

Remarks

Please note: cams with star connection only for cylinder quarter-turns.
1. ramp 2mm
2. stop

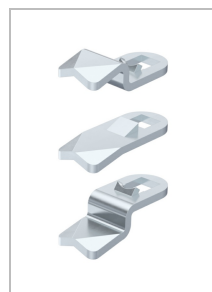

Cam, L-and H-dimension variable

	Part Number	Stop	H-dimension	Length	Delivery Unit
a)	220-0501.00-00000	Yes	13.5 mm	24 mm	10 pcs.
b)	220-0502.00-00000	Yes	19.5 mm	24 mm	10 pcs.
c)	220-0503.00-00000	Yes	7.5 mm	24 mm	10 pcs.
d)	220-10LL.00-Hxxmm	Yes			on request
e)	220-20LL.00-Hxxmm	No			on request

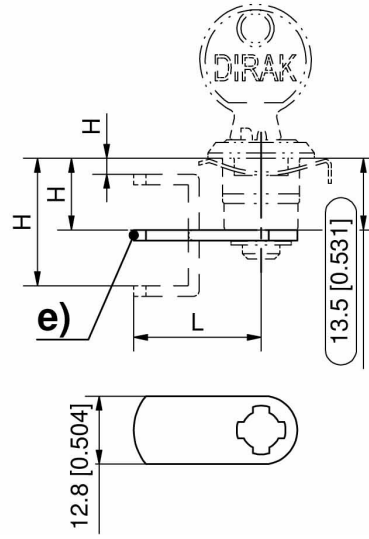
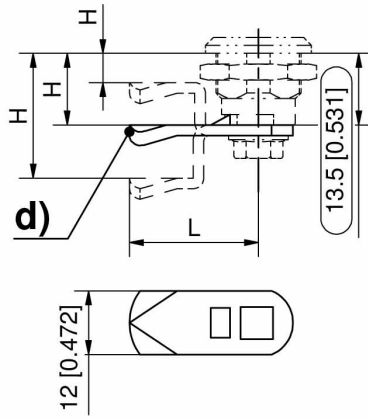
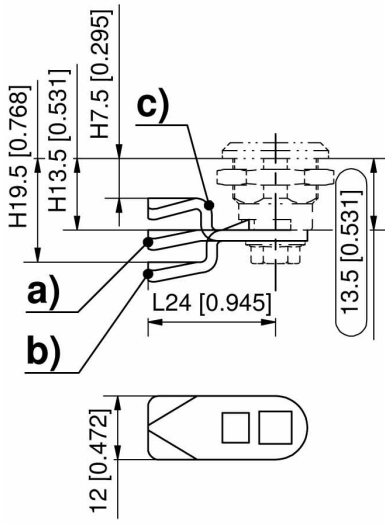



1-059 Finger Pull and Inserts for Quarter-Turn Pr14.1



Advantages

- For head Ø20mm.

Materials

Remarks

1. insert
2. spring washer
3. self-locking screw

By using a finger pull the H-dimension changes by 0.8mm.



Finger pull and inserts

	Part Number	Name	Material	Surface	Delivery Unit
a)	220-1301.00-00000	Finger pull	PA	black	10 pcs.
b)	220-9102.00-00000	Insert Square 6mm	zinc die	chrome plated	10 pcs.
b)	220-9105.00-00000	Insert Square 6mm	zinc die	black	10 pcs.
c)	220-9101.00-00000	Insert Triangular 6.5mm	zinc die	chrome plated	10 pcs.
c)	220-9104.00-00000	Insert Triangular 6.5mm	zinc die	black	10 pcs.
d)	220-9103.00-00000	Insert Slotted 1.5mm	zinc die	chrome plated	10 pcs.
d)	220-9106.00-00000	Insert Slotted 1.5mm	zinc die	black	10 pcs.
e)	220-9118.00-00000	Insert Socket hex. SW 4mm (5/32")	zinc die	chrome plated	10 pcs.
e)	220-9119.00-00000	Insert Socket hex. SW 4mm (5/32")	zinc die	black	10 pcs.
f)	220-9107.00-00000	Insert Socket hex. SW 6mm	zinc die	chrome plated	10 pcs.
f)	220-9127.00-00000	Insert Socket hex. SW 6mm	PA	black	10 pcs.
g)	220-9117.00-00000	Wing Knob Insert	PA / zinc die core	black	10 pcs.

